



Sanitary  
flow  
equipment



Quality  
System  
Certified  
ISO 9001

VA-ZDL Zero Dead Leg dimensions.doc  
Rev.00 Page 1 of 1

## VA-TZDL T Zero Dead Leg valve dimensions

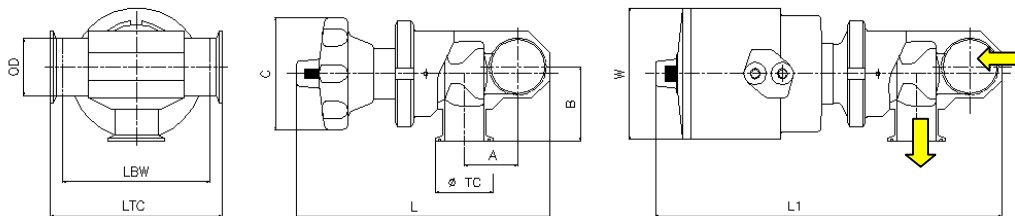

Dimensions table

CODE	VALVE	ØTC	LOOP	OD	A	B	C	LBW	L	L1	W
VAM-ZDL-3/4"x19,05	3/4"	25,0	3/4"	19,05	21	50	100	104	160	200	70
VAM-ZDL-3/4"x25,4		25,0	1"	25,4	24	53	100	104	170	205	70
VAM-ZDL-3/4"x38,1		25,0	1 1/2"	38,1	31	59	100	104	185	215	70
VAM-ZDL-3/4"x50,8		25,0	2"	50,8	37	65	100	104	195	230	70
VAM-ZDL-3/4"x63,5		25,0	2 1/2"	63,5	44	71	100	104	210	245	70
VAM-ZDL-3/4"x76,2		25,0	3"	76,2	51	78	100	104	220	255	70
VAM-ZDL-1"x25,4	1"	50,4	1"	25,4	28	55	100	122	185	235	84
VAM-ZDL-1"x38,1		50,4	1 1/2"	38,1	34	61	100	122	195	245	84
VAM-ZDL-1"x50,8		50,4	2"	50,8	40	67	100	122	210	260	84
VAM-ZDL-1"x63,5		50,4	2 1/2"	63,5	47	73	100	122	225	275	84
VAM-ZDL-1"x76,2	50,4	3"	76,2	54	80	100	122	250	330	84	
VAM-ZDL-1"1/2x38,1	1 1/2"	50,4	1 1/2"	38,1	41	59	100	136	210	295	116
VAM-ZDL-1"1/2x50,8		50,4	2"	50,8	46	66	100	136	225	305	116
VAM-ZDL-1"1/2x63,5		50,4	2 1/2"	63,5	53	72	100	136	235	320	116
VAM-ZDL-1"1/2x76,2	50,4	3"	76,2	60	78	100	136	250	335	116	
VAM-ZDL-2"x50,8	2"	64,0	2"	50,8	53	74	100	160	240	365	140
VAM-ZDL-2"x63,5		64,0	2 1/2"	63,5	59	80	100	160	255	375	140
VAM-ZDL-2"x76,2		64,0	3"	76,2	66	86	100	160	265	390	140

Standard execution : LBW with butt weld connection on loop and clamped outlet port

Special executions available on request :

- LTC with clamp connection on loop
- TFM 1600 PTFE bellow diaphragm for high viscosity products
- Outlet port butt weld or reduct
- CIP/SIP connection clamped or with intercepting valve
- Sample valve welded on main body
- PT100 clamp connection
- Stainless steel handle / pneumatic actuator
- Adjustable flow regulator
- Mechanical / inductive control box

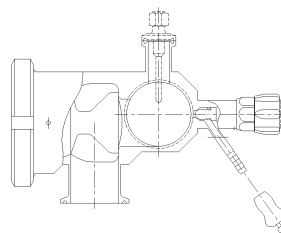

### BENEFITS

- Combination of many different nominal diameter
- Customer's specific design
- Optimized drainability
- Minimized dead leg
- Reduction of fittings, tubing, and field welds in the system
- Reduces surface contact, hold up volume

The application of VA-TZDL valves with U-bend welded is mainly for point of use on distribution loop for pharma

