

TK Syringe device Dimensions

TK- Syringe device for clamp standard according BS 4825

Flush mount hygienic device features a compact design that allow to take sample of product from a tank or in-line in pharmaceutical sector. Before to sampling, the port may be sterilized with alcohol and then sampling takes place by simply penetrating the special silicone gasket with an hypodermic syringe.

Once installed the syringable silicone gasket shut off flush with the inside tank wall with a zero dead leg.

Available in a **unic size of 1"1/2** may be connected on standard clamp according BS 4825 or TK-Connections

Advantages :

- Cost reduction
- No product entrapment
- Easy to use and clean/sterilize
- Autoclavable
- Customized for your needs

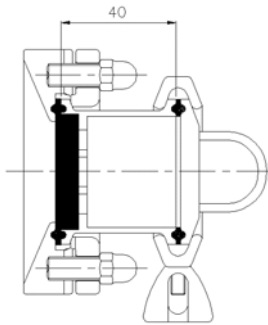

1"1/2 TK-Connection fitted with TK-Syringe
for Tank installation



Design pressure TK holder 7 bar
Design temperature TK holder 200°C

Operating limits conditions :

Max pressure sample liquid 0,5 bar
Max sampling temperature 95°C

Material :

Double clamp port ASTM A 479 / ASTM A 182 – 316L
Blind end cap ASTM A 479 / ASTM A 182 – 316L
Syringable gasket white silicone 60 shore FDA compliance
Clamp assembly AISI 304 stainless steel

Surface finish :

Product contact surface are finish Ra<0,5 micron or better

Marking:

Each TK-Syringe is marked with Heat No. for full lot traceability
Materials certification according EN 10204- 3.1B

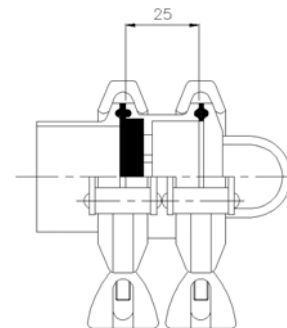

1"1/2 clamp ferrule fitted with TK-Syringe
In-line application

In the interests of development and improvement of the product, we reserve the right to change the specifications without prior notice.