

TKC TKC Connection ASME BPE

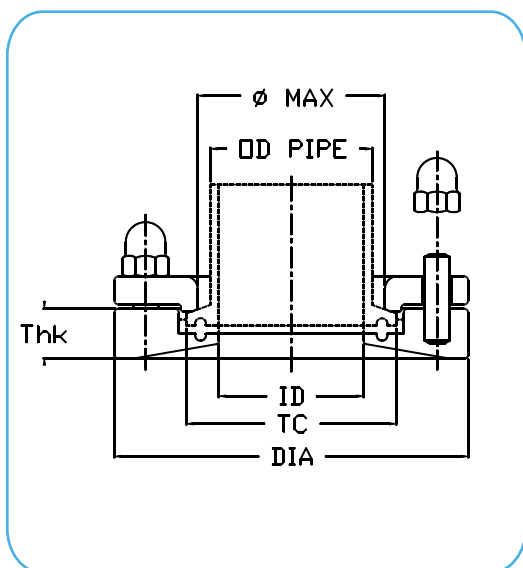

CODE	Size	ØTC	ID	OD pipe	Ømax	DIA	Thk std (mm) #	Thk (mm) #	Thk (mm) #	Thk (mm) #	Bolts
TKC-AG0#-12A	1/2"	25	9.4	12.7	20	55	15	25	38	51	4 x M6
TKC-AH0#-12A	3/4"	25	15.75	19.05	20	55	15	25	38	51	4 x M6
TKC-AJ0#-12A	1"	50.5	22.1	25.4	45	85	17	25	38	51	4 x M8
TKC-AM0#-12A	1 1/2"	50.5	34.8	38.1	45	85	17	25	38	51	4 x M8
TKC-AN0#-12A	2"	64	47.5	50.8	57	100	17	25	38	51	4 x M8
TKC-AO0#-12A	2 1/2"	77.5	60.2	63.5	71	112	17	25	38	51	4 x M8
TKC-AP0#-12A	3"	91	72.9	76.2	85	130	20	25	38	51	6 x M8
TKC-AR0#-12A	4"	119	97.4	101.6	113	170	20	25	38	51	8 x M8
TKC-AV0#-12A	6"	167	146.8	152.4	161	220	30	**	**	**	8 x M10
TKC-AW0#-12A *	8"	217.7	197.8	203.2	210	280	35	**	**	**	8 x M10
TKC-AX0#-12A *	10"	268.5	248.6	254	260	330	45	**	**	**	12 x M10

* according to BS 4825

** on request

Technical Information:

Tri-Clamp Connections: according to ASME BPE

Welding Flange Material: AISI 316L – 1.4404 | on request 1.4435 or other special steels |

Locking Ring Material: AISI 316L – 1.4404

Bolts and Nuts Material: AISI 304 – 1.4301

Internal Surface Finish: Ra ≤ 0.5µm → code **12** e.g.: TKC-AG015-**12A**

Optional: For customized TKC-A Connections, please contact us.

Specifications:

Regulatory: designed according to PED 2014/68/EU directive, ASME VIII Div.2 and F.E.M. (Finite Element Method) calculated, approved and certified by notified body. [except sizes 8" - 10"]

Design Pressure: 7 barg (101,5 psig) [except sizes 8" - 10"]

Design Temperature: -80°C to 200°C (-112°F to 392°F)

Note: The applied gasket (not included) may have different design temperature and/or pressure limits than the TKC. The weakest component in the assembled product determines the maximum design temperature and pressure limits.

Marking: Each TKC Connection is marked with Heat No. for full lot traceability.

CONFIGURATOR



Last updates can be found on our website - www.aerreinox.it

In the interests of development of the product, we reserve the right to change the specifications without prior notice

DATASHEETS

