

# TKC TKC Connection DIN 32676

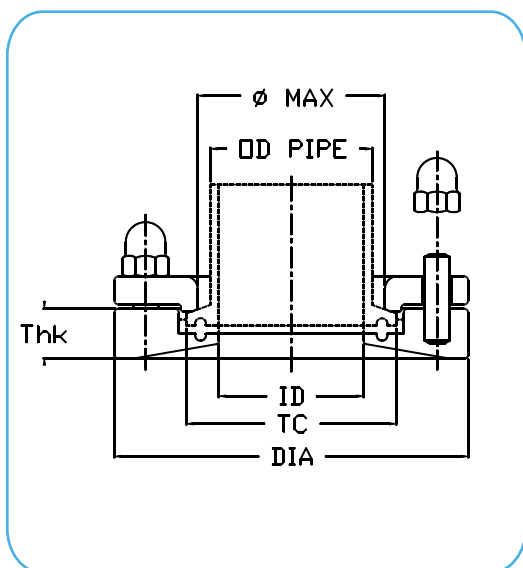

CODE	Size DN	ØTC	ID	OD pipe	Ømax	DIA	Thk std (mm) #	Thk (mm) #	Thk (mm) #	Thk (mm) #	Bolts
TKC-CE0#-12A	10	34	10	12 - 14	26	70	15	25	38	51	4 x M8
TKC-CG0#-12A	15	34	16	18 - 20	26	70	15	25	38	51	4 x M8
TKC-CH0#-12A	20	34	20	22 - 24	26	70	15	25	38	51	4 x M8
TKC-CJ0#-12A	25	50.5	26	28 - 30	45	85	17	25	38	51	4 x M8
TKC-CL0#-12A	32	50.5	32	34 - 36	45	85	17	25	38	51	4 x M8
TKC-CM0#-12A	40	50.5	38	40 - 42	45	85	17	25	38	51	4 x M8
TKC-CN0#-12A	50	64	50	52 - 54	71	100	17	25	38	51	4 x M8
TKC-CO0#-12A	65	91	66	70	85	130	20	25	38	51	6 x M8
TKC-CP0#-12A	80	106	81	85	93	146	20	25	38	51	6 x M8
TKC-CR0#-12A	100	119	100	104	113	170	20	25	38	51	8 x M8

## Technical Information:

**Tri-Clamp Connections:** according to DIN 32676 - REIHE A

**Welding Flange Material:** AISI 316L – 1.4404 | *on request 1.4435 or other special steels* |

**Locking Ring Material:** AISI 316L – 1.4404

**Bolts and Nuts Material:** AISI 304 – 1.4301

**Internal Surface Finish:** Ra ≤ 0.5µm → code **12** e.g.: TKC-CE015-**12A**

**Optional:** For customized TKC-C Connections, please contact us.

## Specifications:

**Regulatory:** designed according to PED 2014/68/EU directive, ASME VIII Div.2 and F.E.M. (Finite Element Method) calculated, approved and certified by notified body.

**Design Pressure:** 7 barg (101,5 psig)

**Design Temperature:** -80°C to 200°C [-112°F to 392°F]

Note: The applied gasket (not included) may have different design temperature and/or pressure limits than the TKC. The weakest component in the assembled product determines the maximum design temperature and pressure limits.

**Marking:** Each TKC Connection is marked with serial number for full lot traceability.

### CONFIGURATOR



### DATASHEETS



Last updates can be found on our website - [www.aerreinox.it](http://www.aerreinox.it)  
In the interests of development of the product, we reserve the right to change the specifications without prior notice