

FERRULE CLAMP ASME BPE - BS 4825

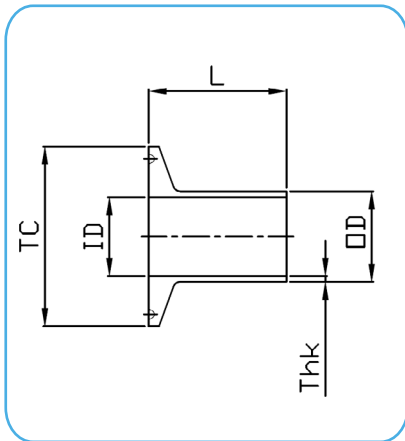

**FERRULE CLAMP
ASME BPE
DT-4.1.4-1**

Technical Information:

Connections: Tri-Clamp according to ASME BPE (latest ed.)

Material: AISI 316L – 1.4404

Internal Surface Finish: SF1 Ra<=0.5µm → code **13** e.g.: L14AM7-A050-**13A**

Optional: SF4 Ra<=0.38µm Electropolish → code **43** e.g.: L14AM7-A050-**43A**

| CODE | Size inch | ØTC (mm) | OD X Thk (mm) | ID (mm) | L SHORT | L MEDIUM | L LONG |
|---------------------|--------------|-------------|---------------|------------|------------------|-------------------|------------------|
| | | | | | (#) 14WMP | (#) L14AM7 | (#) S14AM |
| (#) -A050... | 1/2" | 25 | 12.7 x 1.65 | 9.4 | 12.7 | 28.6 | 44.5 |
| (#) -A075... | 3/4" | 25 | 19.05 x 1.65 | 15.75 | 12.7 | 28.6 | 44.5 |
| (#) -A100... | 1" | 50.5 | 25.4 x 1.65 | 22.1 | 12.7 | 28.6 | 44.5 |
| (#) -A150... | 1" 1/2 | 50.5 | 38.1 x 1.65 | 34.8 | 12.7 | 28.6 | 44.5 |
| (#) -A200... | 2" | 64 | 50.8 x 1.65 | 47.5 | 12.7 | 28.6 | 57.2 |
| (#) -A250... | 2" 1/2 | 77.5 | 63.5 x 1.65 | 60.2 | 12.7 | 28.6 | 57.2 |
| (#) -A300... | 3" | 91 | 76.2 x 1.65 | 72.9 | 12.7 | 28.6 | 57.2 |
| (#) -A400... | 4" | 119 | 101.6 x 2.10 | 97.4 | 15.9 | 28.6 | 57.2 |
| (#) -A600... | 6" | 167 | 152.4 x 2.80 | 146.8 | 19.05 | 38.1 | 76.2 |

Technical Information:

Connections: Tri-Clamp according to BS 4825

Material: AISI 316L – 1.4404

Internal Surface Finish: Ra<=0.5µm → code **13** e.g.: 14WLMO-A800-**13A**

| CODE | Size inch | ØTC (mm) | OD X Thk (mm) | ID (mm) | L (mm) |
|-----------------|--------------|-------------|------------------|------------|-----------|
| 14WLMO-A800-13A | 8" | 217.7 | 203.2 x 2.70 | 197.8 | 28.6 |
| 14WLMO-AA10-13A | 10" | 268.5 | 254.0 x 2.70 | 248.6 | 28.6 |
| 14WLMO-AA12-13A | 12" | 319.3 | 304.8 x 2.70 | 299.4 | 28 |

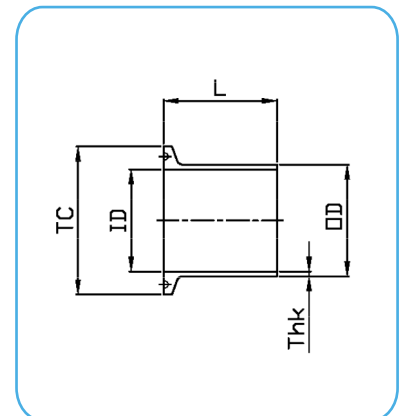

**FERRULE CLAMP
BS 4825**

DATASHEETS



Last updates can be found on our website - www.aerreinox.it
In the interests of development of the product, we reserve the right to change the specifications without prior notice